

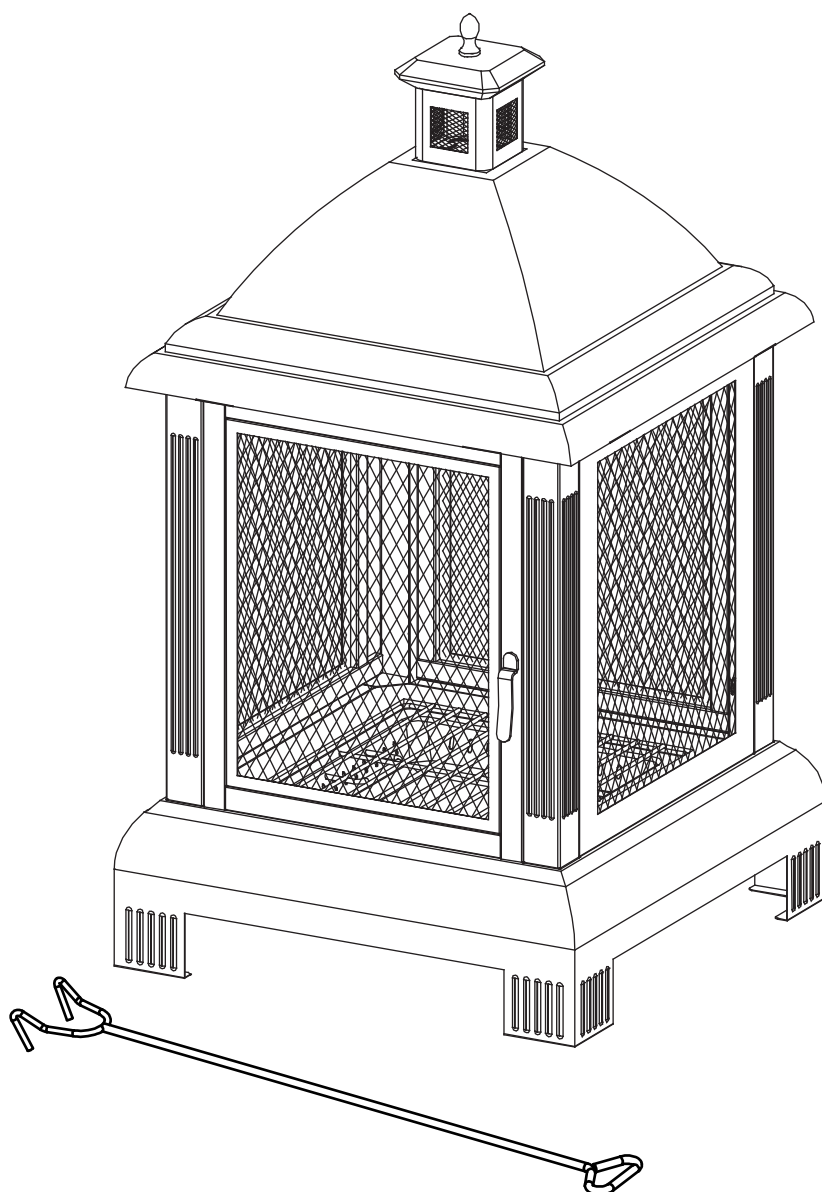

STEEL FIRE PIT

Model #: SRFP41305
Item #: 227768



Questions, problems, missing parts? Before returning to your retailer, call our customer service department at 1-866-814-0585, 8 a.m. to 8 p.m., EST, Monday-Friday. Or e-mail: customerservice@shinerichgroup.com.

Warnings and Cautions

Please read and understand this entire manual before attempting to assemble, operate or install the product.

1. The fire pit is intended for outdoor use only. Keep it at least 12 inches from walls and 36 inches from an overhang. Do not use under or on combustible structures/surfaces including wooden decks.
2. The fire pit is intended to burn wood logs only. Do not burn coal, leaves or other combustibles.
3. For adult use only. Keep children & pets away from fire pit.
4. The fireplace is hot, use with caution. Never touch a hot fire pit with bare hands. Never leave burning fire unattended and always extinguish fire completely when finished with the fire pit.
5. Do not use near flammable or combustible objects or materials.
6. The log rack is not intended for cooking and should not be used for this purpose.
7. The handle of the tools may become hot during and after use.

CALIFORNIA PROPOSITION 65 WARNING

This product can expose you to chemicals including carbon monoxide, which is known to the State of California to cause birth defects or other reproductive harm. For more information, go to www.P65Warnings.ca.gov.

Preparation

Suggest two people assemble this product.

Before beginning assembly of product, make sure all parts are present.

Compare parts with package contents list and diagram above. If any part is missing or damaged, do not attempt to assemble the product. Contact customer service for replacement parts.

- Estimated assembly time: 15 minutes
- Tools required for assembly: Phillips screwdriver.
3/8-in. open-end wrench.
(Tools not included)

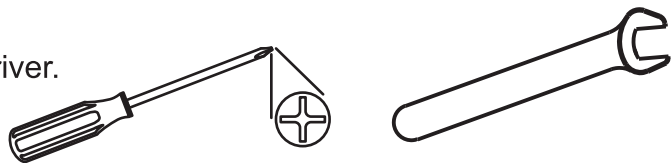

Package Contents

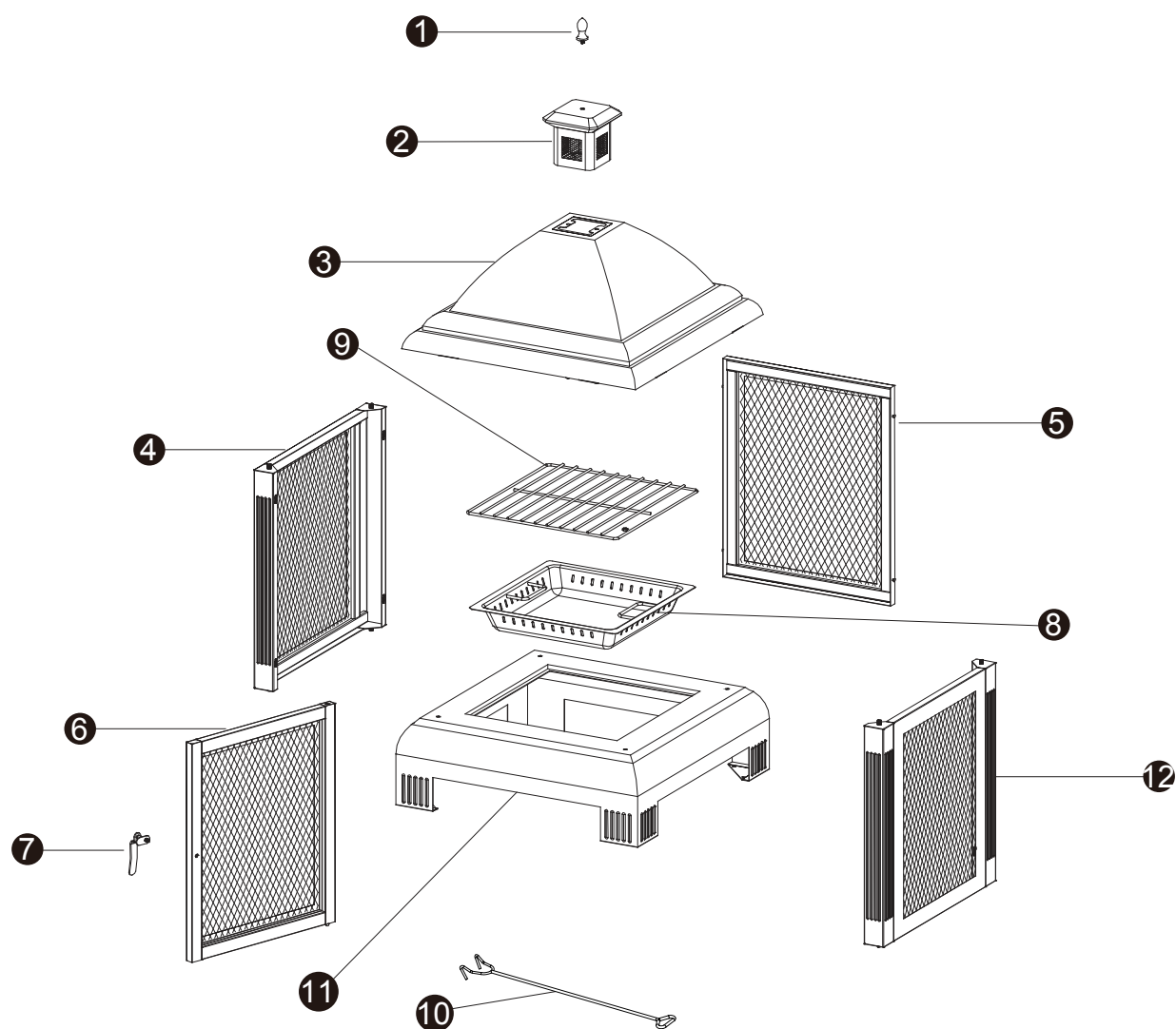

PART LIST

No.	Part	Qty
1	Chimney Cap Ring	1
2	Chimney Cap	1
3	Chimney	1
4	Side Screen/Left	1
5	Back Screen	1
6	Front Screen/Door	1
7	Handle and Lock Plate	1
8	Ash Container	1
9	Grate	1
10	Poker	1
11	Base	1
12	Side Screen/Right	1

HARDWARE LIST

No.	Hardware	Qty
A	M5X10 Screws	2
B	φ 10 (φ 8) X30 Pin	1

Assembly Instructions

Step1: Attach Side screen/left(4) and Side screen/right(12) to Base(11).
Pls note: donot screw firmly until four side screens fixed well.

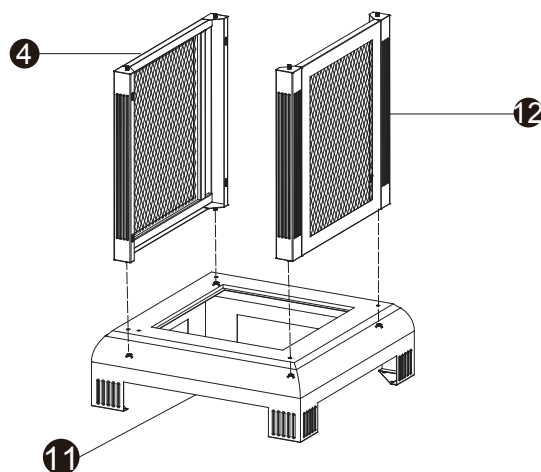

Step 2: Attach back screen(5) to side screen/left(4) and side screen/right(12) as the right picture showing.

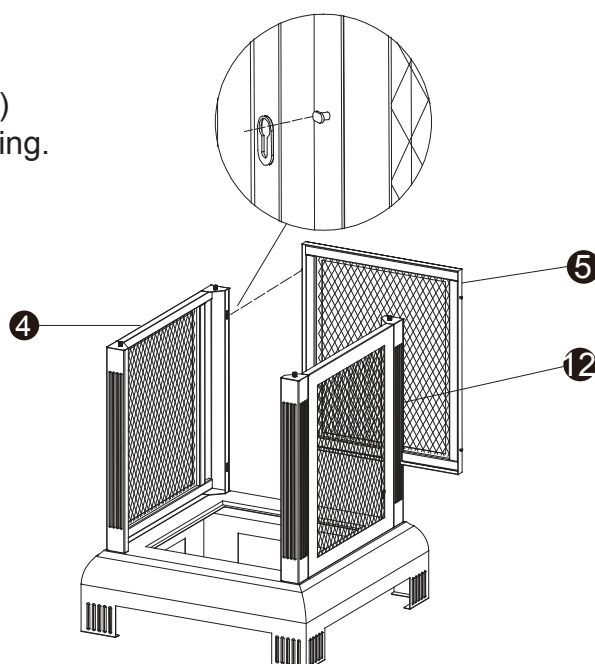

Step 3: Attach lid(3) to side screen/left(4) and side screen/right(12).

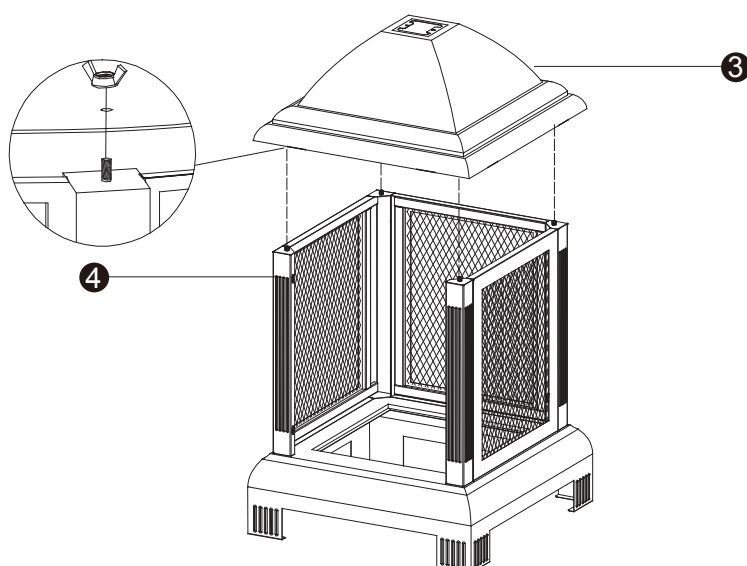

Assembly Instructions

Step 4: Attach front screen/door(6) to side screen/left(4) as the right picture showing using pin(B), then attach handle and lock plate(7) to front screen/door(6).

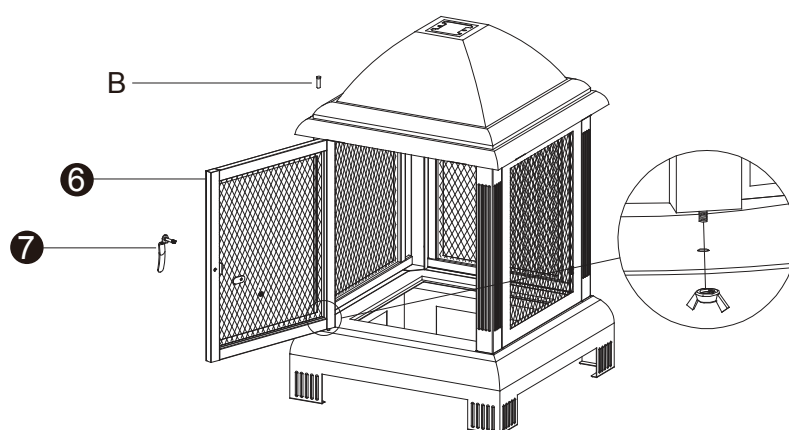

Step 5: Screw chimney cap ring(1) to chimney cap(2), then connect the chimney cap(2) to chimney(3) using two M5X10 Screws (A).

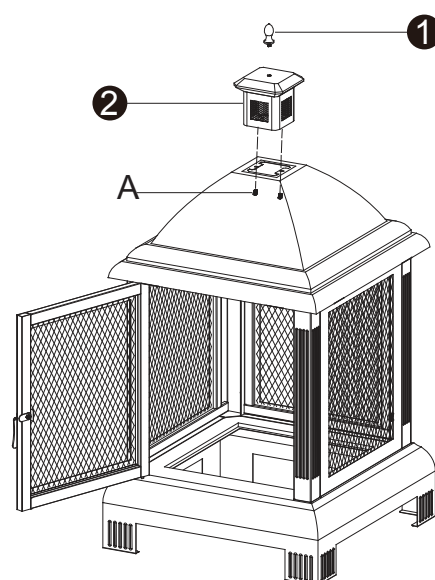

Step 6: Place ash container(8) and grate(9) into firehouse.

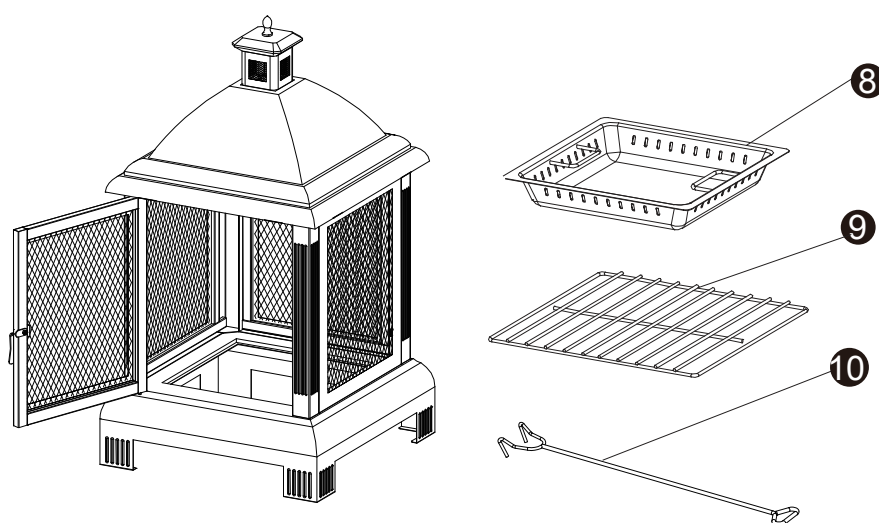

Assembly Instructions

Step 7: Assembly completed.

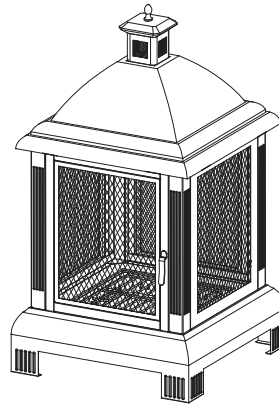

Safety Instruction

Lighting Instruction

1. Open the screen door using the fire tool, put the firewood/charcoal on the grate. Do not overload this fire pit.
2. Put dry wood scraps under firewood/charcoal, light them. Close the screen.
3. Put fire out!! Make sure the fire is completely out before you leave.
4. Make sure the fire is completely out before you clean the fire bowl.
5. Care, maintain and clean this fire pit.

Care and Maintenance

Inspecting

This fire pit should be inspected on a regular basis to ensure product safety and longer product life. DO NOT attempt to inspect this fire pit until the fire is COMPLETELY out and cooled down.

1. Check components for any signs of damage or rust.
2. If damage to any component is detected, do not operate until repairs are made.

Cleaning

This fire pit should be cleaned on a regular basis to promote safer experiences and longer product life.

Note: After repeated use, a slight discoloration of the finish may occur.

DO NOT attempt to clean this fire pit until the fire is COMPLETELY out and cool down.

DO NOT use oven cleaner or abrasive cleaners as they will damage this product.

DO NOT clean any part of this fire pit in a self-cleaning oven as it may damage its finish.

1. Wipe exterior surface with a mild dishwashing detergent or baking soda.
2. Store this fire pit in a dry location to maximize product life.
3. Clean with water.

Storing

DO NOT move or store this fire pit until the fire COMPLETELY out and cooled down.

1. Once the fire is out (fire pit is cool to the touch), remove ashes and properly dispose.
2. Store this fire pit in a dry location to maximize product life.
3. Store assembled in a location away from children and pets.
4. Cover outdoor fire pit with the PVC cover (Not included).

One Year Limited Warranty

The appliance has been manufactured under the highest standards of quality and workmanship. We warrant to the original consumer/purchaser that all aspects of this product will be free of defects in material and workmanship for one (1) year from the date of purchase. A replacement for any defective part will be supplied free of charge for installation by the consumer. Defects or damage caused by the use of other than genuine parts are not covered by this warranty. This warranty shall be effective from the date of purchase as shown in the purchaser's receipt.

This warranty is valid for the original consumer/purchaser only and excludes industrial, commercial or business use of the product, product damage due to shipment or failure which results from alteration, product abuse, or product misuse, whether performed by a contractor, service company, or consumer. We will not be responsible for labor charges and/or damage incurred in installation, repair or replacement, nor for incidental or consequential damage. This warranty gives you specific rights, and you may also have other rights that vary from state to state.



Need help?
call our toll free number at:
1-866-814-0585 or
e-mail us at:
customerservice@shinerichgroup.com